

Keylock Switches

Antistatic Process Sealed Keylock Switches

SK Series

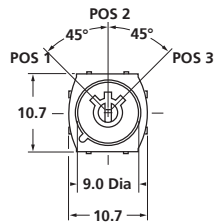

3 Position

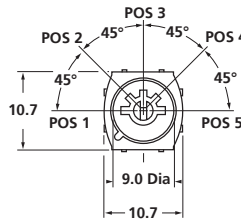

5 Position

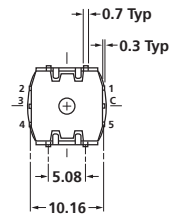
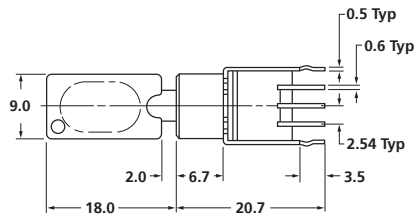

SK13AEG13

Straight PC with Bracket

On 3-position models terminals 1 & 5 are support pins.

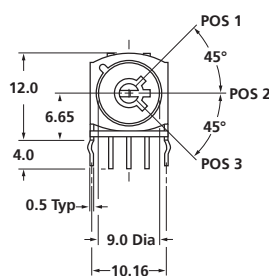
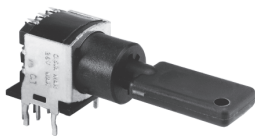

3 Position

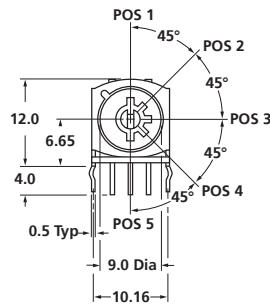

5 Position

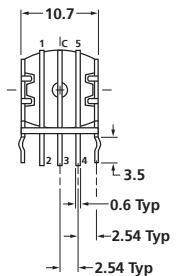
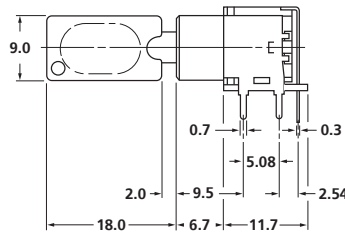

SK15AEG30

Right Angle PC

On 3-position models terminals 1 & 5 are support pins.

Keylock Switches

POLES, CIRCUITS & KEY-REMOVABLE POSITIONS

CUTAWAY

Pole & Throw	Model	Key Positions					Connected Terminals					Schematic	Legend	
		Pos 1	Pos 2	Pos 3	Pos 4	Pos 5	Pos 1	Pos 2	Pos 3	Pos 4	Pos 5			
SP3T	SK13A	ON	ON	ON	---	---	COM-1	COM-2	COM-3	---	---			
SP5T	SK15A	ON	ON	ON	ON	ON	COM-1	COM-2	COM-3	COM-4	COM-5			

KEY

STRAIGHT PC TERMINALS WITH BRACKET

RIGHT ANGLE PC

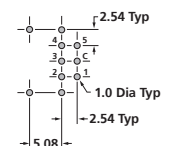
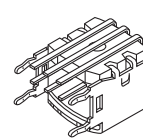
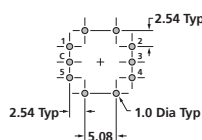
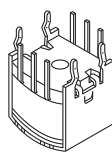
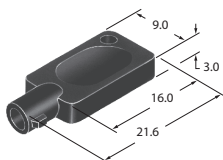

How to order:

SK

- 1** POLES:
1 SP3T / SP5T
- 2** POSITIONS:
3 ON-ON.ON.NONE-NONE
5 ON-ON-ON-ON-ON
- 3** KEY REMOVABLE:
A All Positions

- 4** BUSHING:
E 9mm Diameter Smooth
- 5** CONTACT MATERIAL:
G Gold, Rated 0.4VA @ 28V AC/DC
- 6** TERMINALS:
13 Straight with Bracket
30 Right Angle

General Specifications:

ELECTRICAL CAPACITY (Resistive Load)
 » Logic Level: 0.4VA @ 28 V AC/DC max.
OTHER RATINGS:
 » Contact Resistance: 100mΩ max.
 » Insulation Resistance: 100MΩ min.@500VDC
 » Mechanical Life: 30,000 cycles min.
 » Electrical Life: 20,000 cycles min.
 » Nominal Operating Torque: 0.0002Nm
 » Contact Timing: Break-before-make
 » Angle of Throw: 45° for 3-position & 5-position
MATERIALS
 » Terminals: Phosphor bronze with tin plating
 » Movable Contact: Beryllium copper with gold plating
 » Stationary Contacts: Phosphor bronze with tin plating
ENVIRONMENTAL DATA
 » Operating Temperature: -25°C through +70°C
SOLDERING
 » Wave Soldering recommended. Manual Soldering 4 sec. max. @ 390°C max.

